

LH-1256L Specification



High Performance Helix Antenna

LH-1256L is an active GNSS antenna for all bands of GPS/QZSS, GLONASS, GALILEO, BEIDOU and NAVIC. It also supports L band from 1525MHz to 1559MHZ. The antenna is light and low power consumption that is ideal for applications requiring RTK level positioning accuracy, such as self-driving vehicle,UAV, aerial photography, high precision mapping, remote sensing, traffic control and public security.

Passive antennaperformance	
Frequency	GPS: L1, L2, L5 GLONASS: L1, L2, L3 GALILEO: E1, E5a, E5b, E6 BEIDOU: B1I, B1C, B2a, B2b, B3I NAVIC: L5 QZSS: L1, L2, L5, L6 LBand: 1525 MHz - 1559 MHZ
Polarization	RHCP
Axial ratio	$\leq 3\text{dB}$
Peak gain	3.0dBi
RF specification	
Conducted gain	36.4±3dB
Noise figure	$\leq 2\text{dB}$
Output impedance	50Ω
Out of band rejection	40dB
Operating voltage	2.1V ~ 18V
Operating current	13.5 mA typ.
ESD	Air ±15KV, contact ±8KV
Mechanical specification	
Connector type	SMA male
Dimension	65.5D x 37.5Hmm
Weight	$\leq 45\text{g}$
Environment	
Operating temperature	-40 ~ 85℃
Storage temperature	-40 ~ 85 °C
Waterproof	IPX7

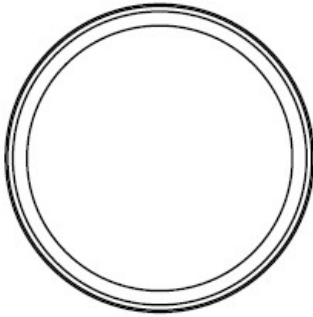

TOP VIEW

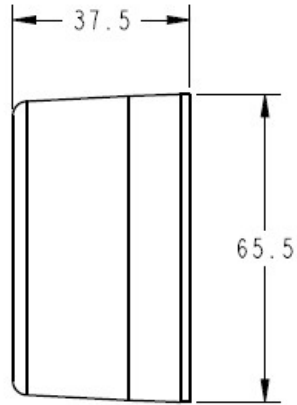

SIDE VIEW

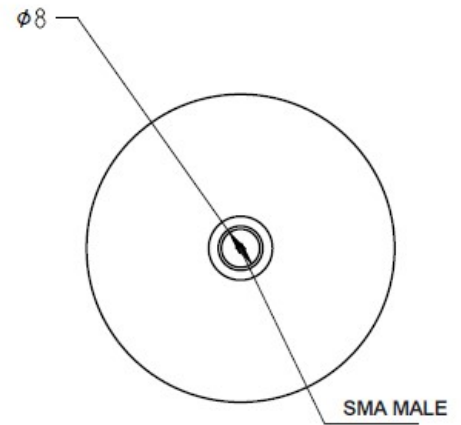

BOTTOM VIEW

UNIT:mm